

INSTRUCTION MANUAL

- 1. Always ensure the power is completely OFF before any installation or maintenance.**
- 2. The fixture must be installed by a qualified licensed electrician**

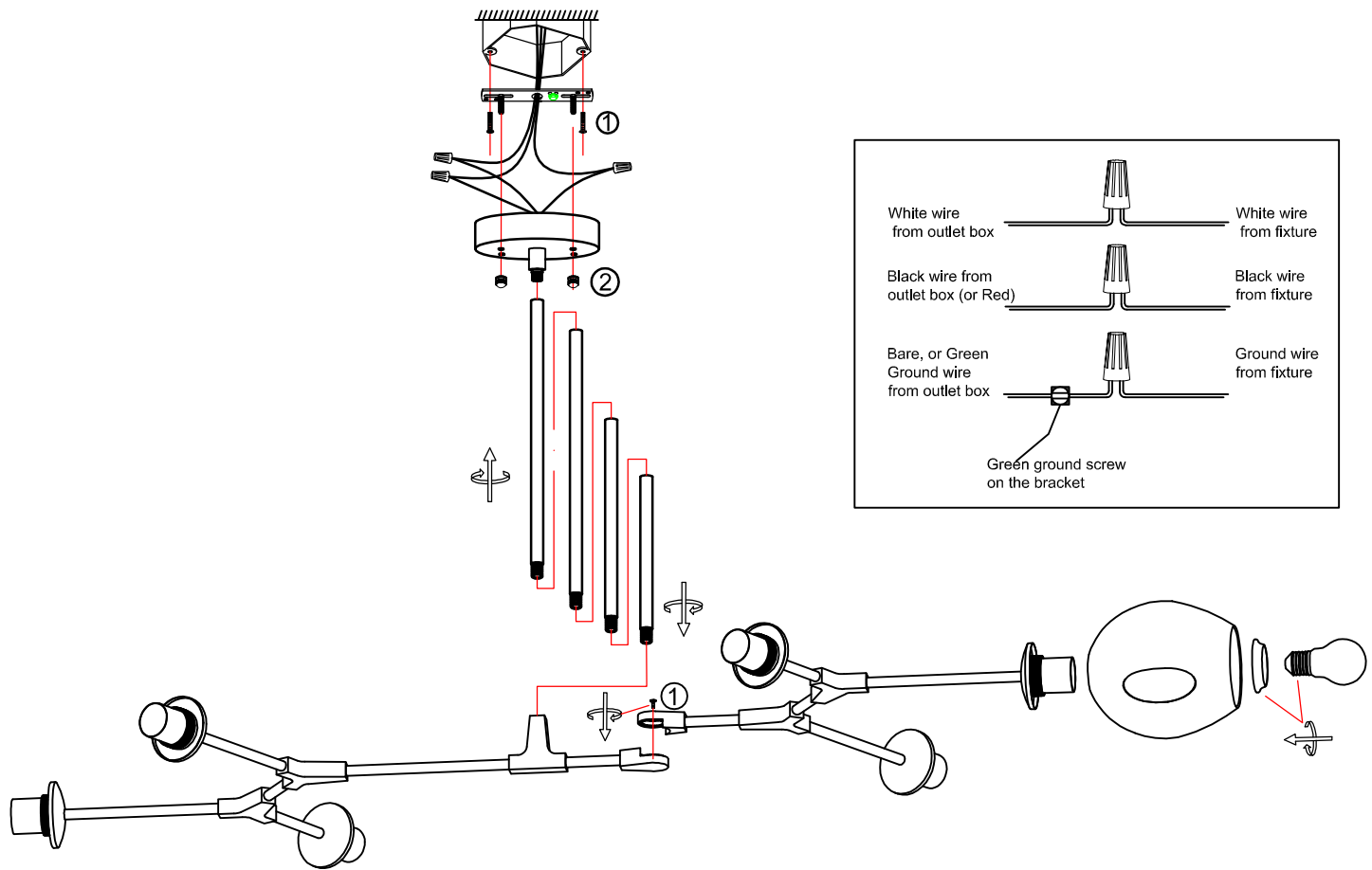

- 1. Ensure main supply is switched off.**
- 2. Put connectors together and use screw (1) to tighten them.**
- 3. Make wire across rods, canopy in order, and screw down all rods**
- 4. Have the mounting screw (2) through the mounting bracket and screw into octagon box.**
- 5. Connect the wires using wire nuts. Tight mounting bracket and back plate using screws (3).**
- 6. Fix the glass shade firmly into fixture with outer ring.**
- 7. Install light bulb (not provided) into the socket.**

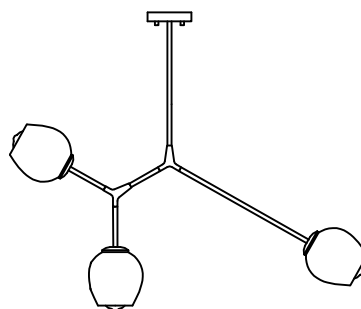

**P2069-3BK
P2069-3CH
P2069-3AB**

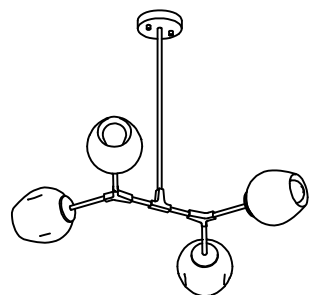

**P2069-4BK
P2069-4CH
P2069-4AB**

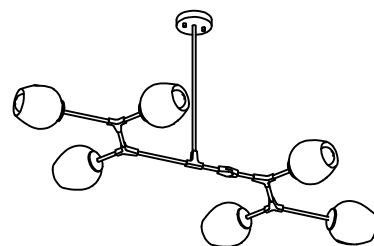

**P2069-6BK
P2069-6CH
P2069-6AB**